



**RECORD OF TITLE
UNDER LAND TRANSFER ACT 2017
FREEHOLD
Search Copy**



R. W. Muir
Registrar-General
of Land

Identifier SA60B/955
Land Registration District South Auckland
Date Issued 30 May 1997

Prior References
SA59A/785

Estate Fee Simple
Area 707 square metres more or less
Legal Description Lot 89 Deposited Plan South Auckland
76047

Registered Owners

Timothy Gareth Pease as to a 1/2 share
Michelle Patricia Pease as to a 1/2 share

Interests

Subject to Section 11 Crown Minerals Act 1991
Subject to Part IV A Conservation Act 1987
Land Covenant in Transfer B418573.4 - 30.5.1997
Fencing Covenant in Transfer B450127.1 - 14.11.1997 at 10.00 am
11526730.3 Mortgage to Michael James Pease, Judith Carol Pease and Fiona Michele Pease - 4.9.2019 at 2:00 pm

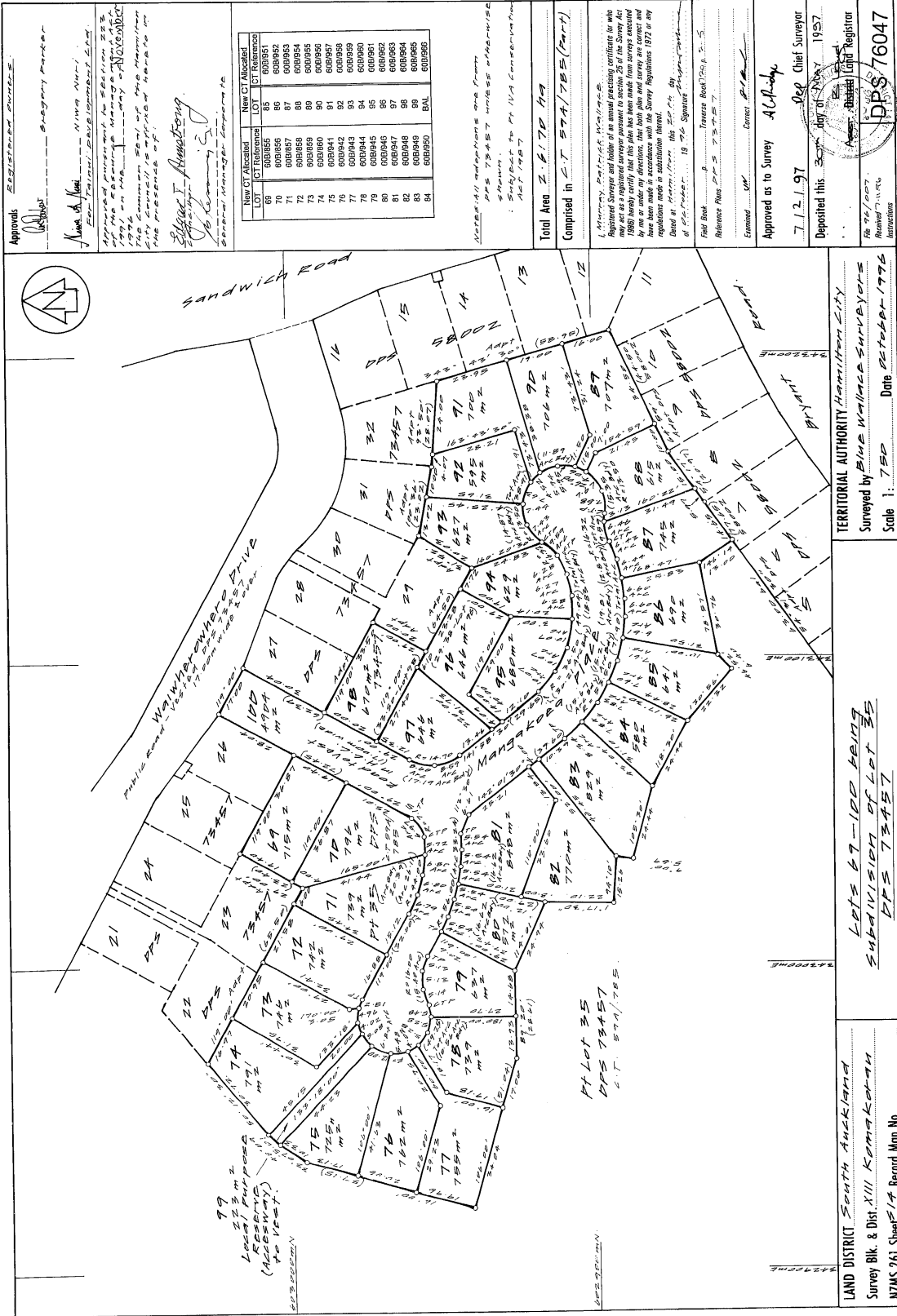

Approvals
 Approved by: *[Signature]* Deputy Registrar
 Approved by: *[Signature]* Chief Surveyor

[Handwritten notes and signatures]

LOT	CT Reference	New CT Abstract	LOT	CT Reference
69	600865	85	600861	
70	600866	86	600862	
71	600867	87	600863	
72	600868	88	600864	
73	600869	89	600865	
74	600870	90	600866	
75	600871	91	600867	
76	600872	92	600868	
77	600873	93	600869	
78	600874	94	600870	
79	600875	95	600871	
80	600876	96	600872	
81	600877	97	600873	
82	600878	98	600874	
83	600879	99	600875	
84	600880	BAL.	600876	

Total Area 2.6170 H^a
 Comprised in 2 T 574/785 (part)

Approved as to Survey A. C. [Signature]
 Chief Surveyor
 Deposited this 30th day of May 1957
 Date of Registration the 20th day of June 1957
 Received from the Registrar
 PPS 76047
 Instructions

LAND DISTRICT South Auckland
 Survey Bk. & Dist. XIII Koro-koro
 NZMS 261 Sheet 14 Record Map No.

TERRITORIAL AUTHORITY Hamilton City
 Surveyed by Bina Wallace Surveyors
 Scale 1: 750 Date October-1996

